

MODEL 65058S

STAINLESS STEEL, WELDED SEAL DOUBLE-ENDED SHEAR BEAM LOAD CELL

APPLICATIONS

- Hostile environments
 - Food and beverage processing
 - Chemical and plastics processing
 - Pharmaceutical and biomedical processing
- Washdown and clean-in-place
- High performance weighing modules and assemblies
- Tank and reactor weighing
- Batching, blending and mixing systems

FEATURES

- Rated capacities of 10,000 to 100,000 pounds
- Stainless steel, welded seal construction
- Center-link loaded
- 65058-TSA companion assemblies for vehicle scales
- 65069-TWA companion assemblies for vessel weighing
- Insensitive to side loads and bending moments
- Load cells have matched outputs for multi-cell systems
- Integral conduit adaptor
 - Trade certified for NTEP Class III:5,000 divisions and Class III L:10,000 divisions
 - **Sensorgage™** sealed to IP66/67 standards
 - **Cell Guard™** Two Year Warranty
 - Factory Mutual System Approved for Classes I, II, III; Divisions 1 and 2; Groups A through G. Also, **Non-Incendive** (No Barriers!).
 - ISO 9001 Certified manufacturing facilities



ISO
9001



Factory
Mutual
System
Approved



65069-TWA



65058-TSA

Les Balances LEDUC & THIBEAULT Inc.

Montréal : (514) 239-7060 Mercier : (450) 691-2111 Fax : (450) 691-6764
visit our website at www.leduc-thibeault.com E-mail: info@leduc-thibeault.com

Model 65058S Performance Specifications

Rated Capacities (lbs): 10K, 25K, 40K, 50K, 60K, 75K, 100K
 Full Scale Output (FSO): 3.0 mV/V \pm 0.25%

Accuracy Class:	Standard	NTEP III	NTEP III L
Max. No. Verification Intervals	--	5,000 Multiple	10,000 Multiple
Combined Error % FSO	$\leq .03$	--	--
Non-Linearity % FSO	$\leq .03$	--	--
Hysteresis % FSO	$\leq .02$	--	--
Creep Error % FSO	≤ 0.03 in 20 minutes	--	--
Temperature Effect on:			
• Zero % FSO/°F	≤ 0.0015	--	--
• Output % of Load/°F	≤ 0.0008	--	--
Non-Repeatability % FSO		$\leq .01$	
Zero Balance % FSO		≤ 1.0	
Insulation Resistance		> 1000 Mohms at 50VDC	
Compensated Temperature Range		14° to 104°F / -10° to 40°C	
Operating Temperature Range		0° to 150°F / -18° to 65°C	
Storage Temperature Range		-60° to 185°F / -50° to 85°C	
Input Resistance		686-714 Ohms	
Output Resistance		699-707 Ohms	
Recommended Excitation Voltage		15 Volts DC	
Maximum Excitation Voltage		25 Volts DC	
Sideloading Rejection Ratio		500:1	
Safe Sideloading		100% of Rated Capacity	
Safe Overload		150% of Rated Capacity	
Ultimate Overload		300% of Rated Capacity	
Sealing		Meets IP66/67 Standards	
Material		17-4 PH Stainless Steel	

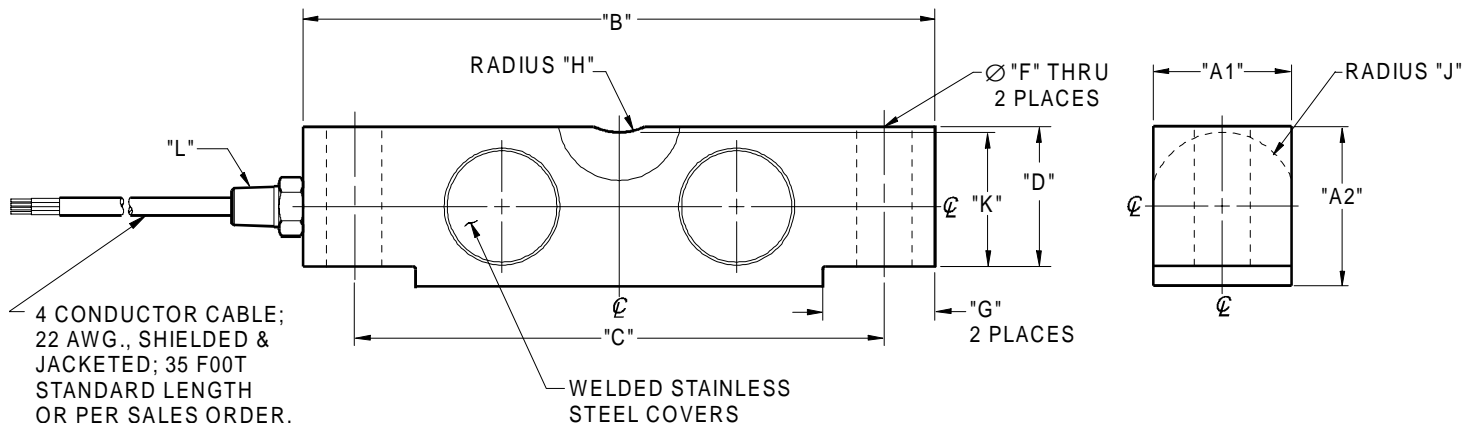

WIRING

FUNCTION	COLOR
+ Excitation	Red
- Excitation	Black
+ Output	Green
- Output	White

CAPACITY	A1	A2	B	C	D	F	G	H	J	K	L	Deflection	Weight
10K - 25K	1.69	1.94	7.75	6.50	1.70	0.68	1.38	0.75	0.90	1.63	1/4-18 NPT	0.014	6.2
40K	1.94	2.44	10.25	8.50	2.10	0.81	1.93	1.00	1.12	2.00	1/4-18 NPT	0.016	11.0
50K - 75K	2.44	2.94	10.25	8.50	2.65	1.06	1.93	1.00	1.37	2.54	1/2-14 NPT	0.020	15.1
100K	2.44	3.44	10.25	8.50	2.65	1.06	1.93	1.00	1.37	2.54	1/2-14 NPT	0.020	25.0

Dimensions are in inches. Capacities are in pounds. Deflection is $\pm 10\%$. Specifications are subject to change. Certified drawings are available.

Les Balances LEDUC & THIBEAULT Inc.

Montréal : (514) 239-7060 Mercier : (450) 691-2111 Fax : (450) 691-6764
 visit our website at www.leduc-thibeault.com E-mail: info@leduc-thibeault.com